

# duraflo® INSTALLATION GUIDE

Installation of Duraflo **WeatherPRO® PRO50 Roof Vent** should comply with all local standards and regulations. Before beginning a job, determine how much ventilation is required in both soffit and roof vents and what sizes of vent would best suit the job. If required, refer to Duraflo Ventilation Calculator for guidance.

## For New Construction or Re-Roofing

### 1. Determine the location of vents:

Evenly space the roof vents along the width of the roof, marking the location of all roof vents before cutting holes. Centre the holes between the rafters within two feet (24") from the peak of the roof.

### Cut and prepare the opening:

Cut the holes in the sheathing before applying shingles. Shingle up until the first full course of shingles covers the bottom of the hole. Cut the excess shingles away from the hole.

### 2. Position the vent and nail the vent in place:

Duraflo Roof Vents have a top arrow indicator. Make sure the throat of the vent is in the proper position centered over the opening. Using the pre-marked nail holes, nail the vent securely into place.

### 3. Complete the shingle installation:

Continue installing shingles, overlapping the flange of the vent. Cut the shingles around the top of the vent to match its shape.

Please Read **Caution** Below.

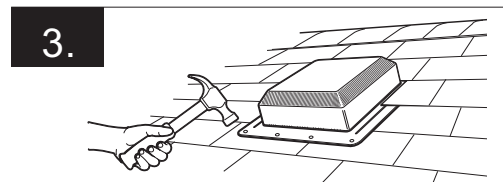
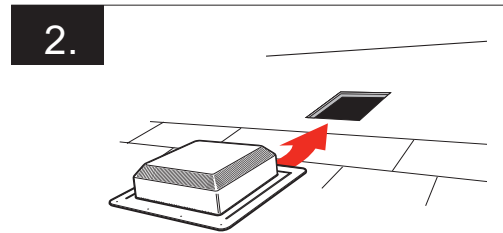
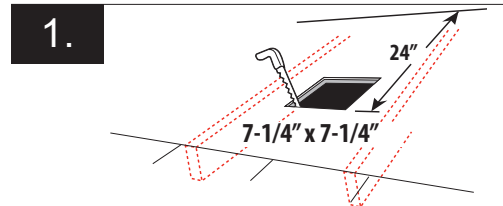

## Adding Ventilation to Finished Roofs

### 1. Determine the location of the vents:

Determined how much additional ventilation is required and the best location for the holes. Inspect the attic to determine the location of rafters and other obstructions. Evenly space the roof vents along the width of the roof, marking the location of all roof vents before cutting holes. Centre the holes between the rafters within two feet (24") from the peak of the roof.

### Cut and prepare the opening:

Using a sharp knife, cut away shingles. Cut through the sheathing using a keyhole saw or electric reciprocating saw. Carefully remove the roofing nails within 3" of the hole. Cut the shingles at the top of the hole to accommodate the molded peak of the roof vent.

### 2. Position the vent:

Duraflo Roof Vents have a top arrow indicator. Slide the vent into place beneath the shingles ensuring that the throat of the vent is centered on the hole. The shingles should overlap the top half of the vent flange. The bottom half of the vent's flange will be exposed on top of the shingles.

### 3. Nail the vent into place:

Nail the vent into place, using the pre-marked holes. Replace nails in the shingles as necessary to ensure a proper seal.

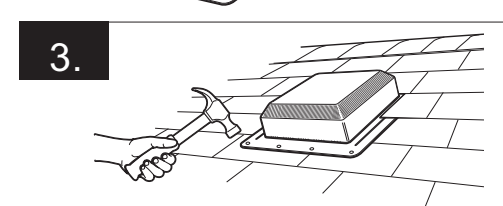
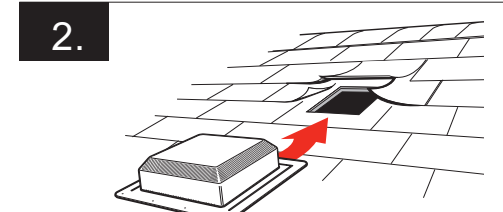
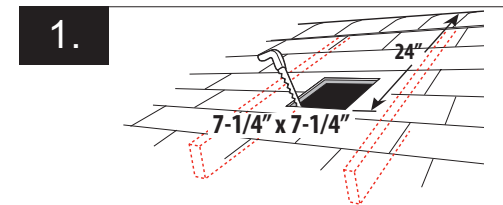

**Caution:** DO NOT USE roofing cement /roofing tar to seal the vent to the roof. The wide flange and molded-in water guards will force the water down the roof over the shingles. The polypropylene flange is large enough and flexible enough to effectively self seal against the roof without the aid of roofing tars. Roofing tars are potentially damaging to the roof vent and the asphalt shingles. Use of roofing tar will void any warranty on the Duraflo Roof Vents. Optional: Seal all nail heads with an approved sealant, such as silicone. Make sure the sealant is a non-petroleum product (usually available in a plastic tube).

Canplas Industries Ltd.  
PO Box 1800, 500 Veterans Drive  
Barrie, Ontario, Canada L4M 4V3  
Tel: (705) 726-3361  
Toll Free 1-800-461-5307  
Fax: (705) 726-2186

Canplas LLC  
11402 East 53rd Ave.  
Suite 200, Denver, CO, U.S.A. 80239  
Tel: (303) 373-1923  
Toll Free: 1-800-461-5307  
Fax: (303) 373-1928

**canplas®**

an *OAliaxis* company

[www.duraflo.com](http://www.duraflo.com)